

RM of Good Lake
No. 274

RM of Sliding Hills No. 273

RM of Cole
No. 271

EHENEZER

SASKATCHEWAN

Map 1. Recreational Amenities

RURAL MUNICIPALITY OF WALLACE No. 243

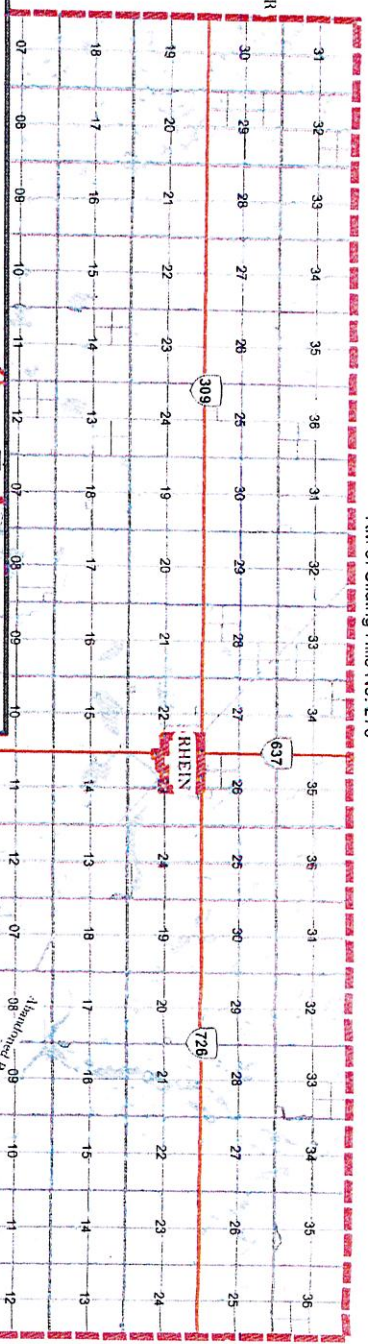

Keyey No. 244

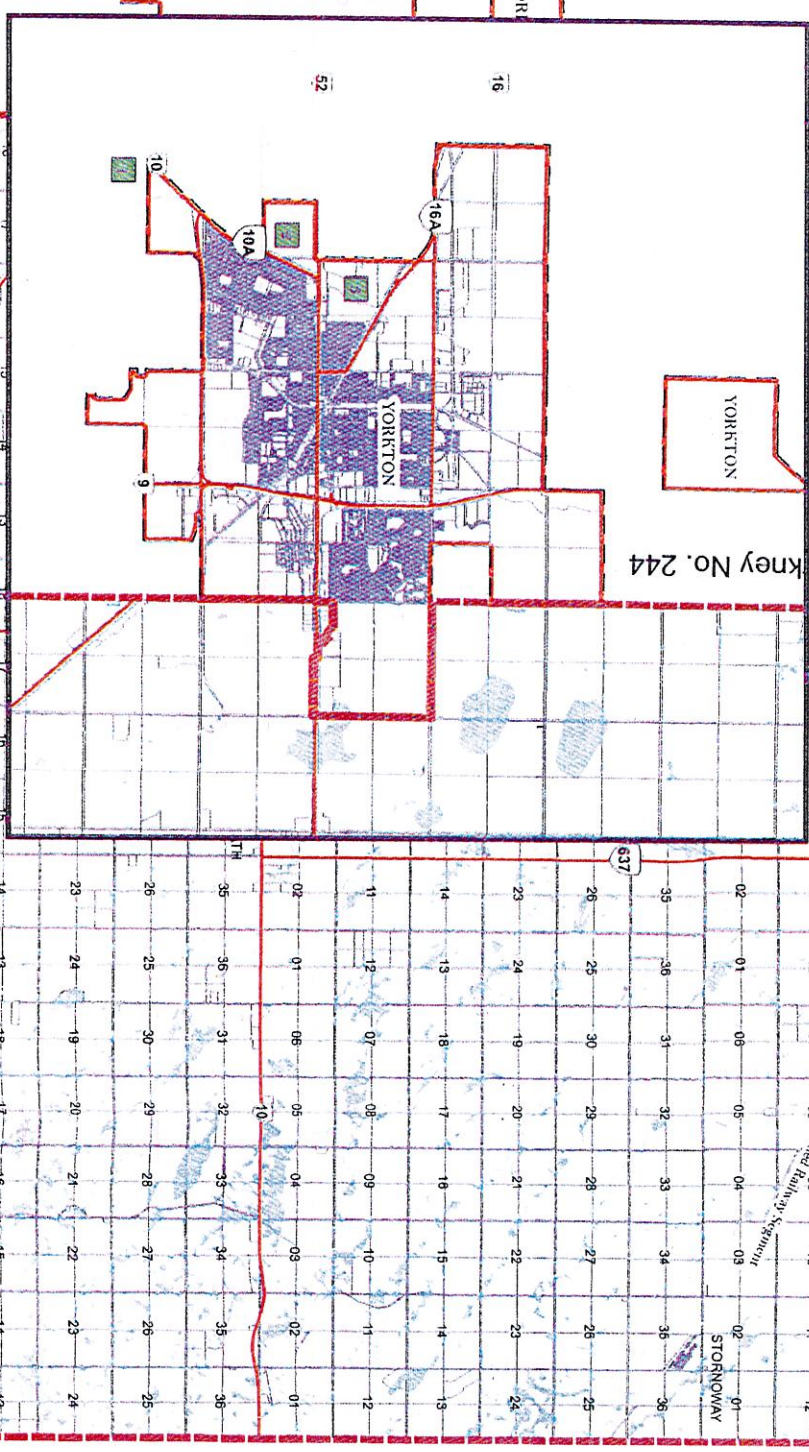

RM of Cana
No. 214

RGE 3

RGE 2
RM of Salcoats No. 213

RGE 1

RM of Churchbridge
No. 211

TWP 25

TWP 26

TWP 27

RM of Calder No. 241

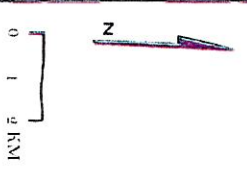

- King's Sport Leisure & Marine
- York Lake Golf & Country Club
- Deer Park Municipal Golf Course
- Ravine Ecological Preserve
- Major Highways
- Railways
- Watercourse
- Waterbody
- Urban Municipality
- RMT Boundary

RM of Good Lake No. 274
 RM of Sliding Hills No. 273
 RM of Cole No. 271

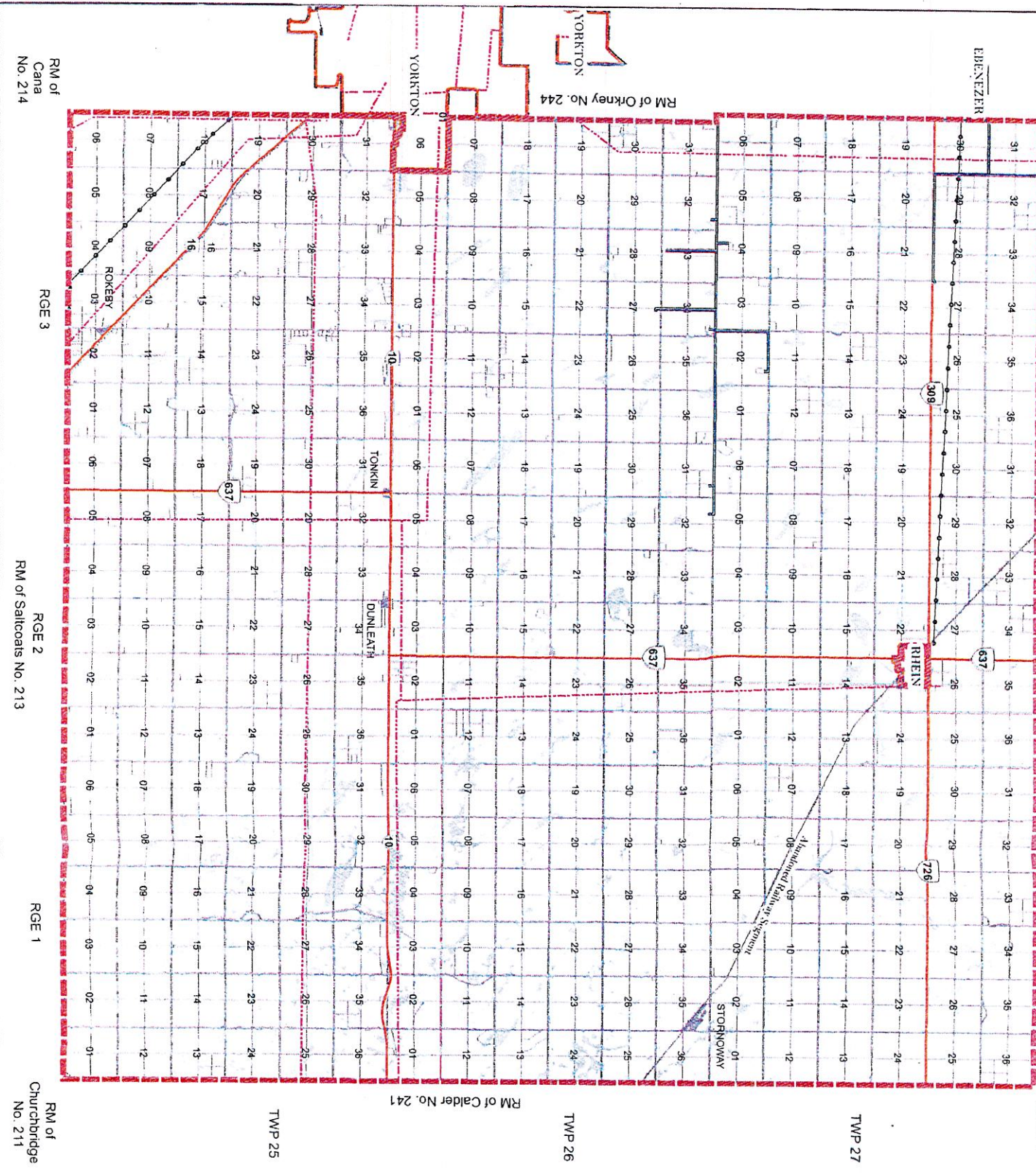

RURAL MUNICIPALITY OF WALLACE No. 243

SASKATCHEWAN

Map 2. Utilities

- Major Highways
- Railways
- Watercourse
- Waterbody
- Urban Municipality RM Boundary
- Yorkville Water Utility
- TransGas Underground Utility
- Power Line

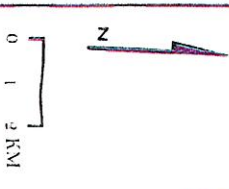

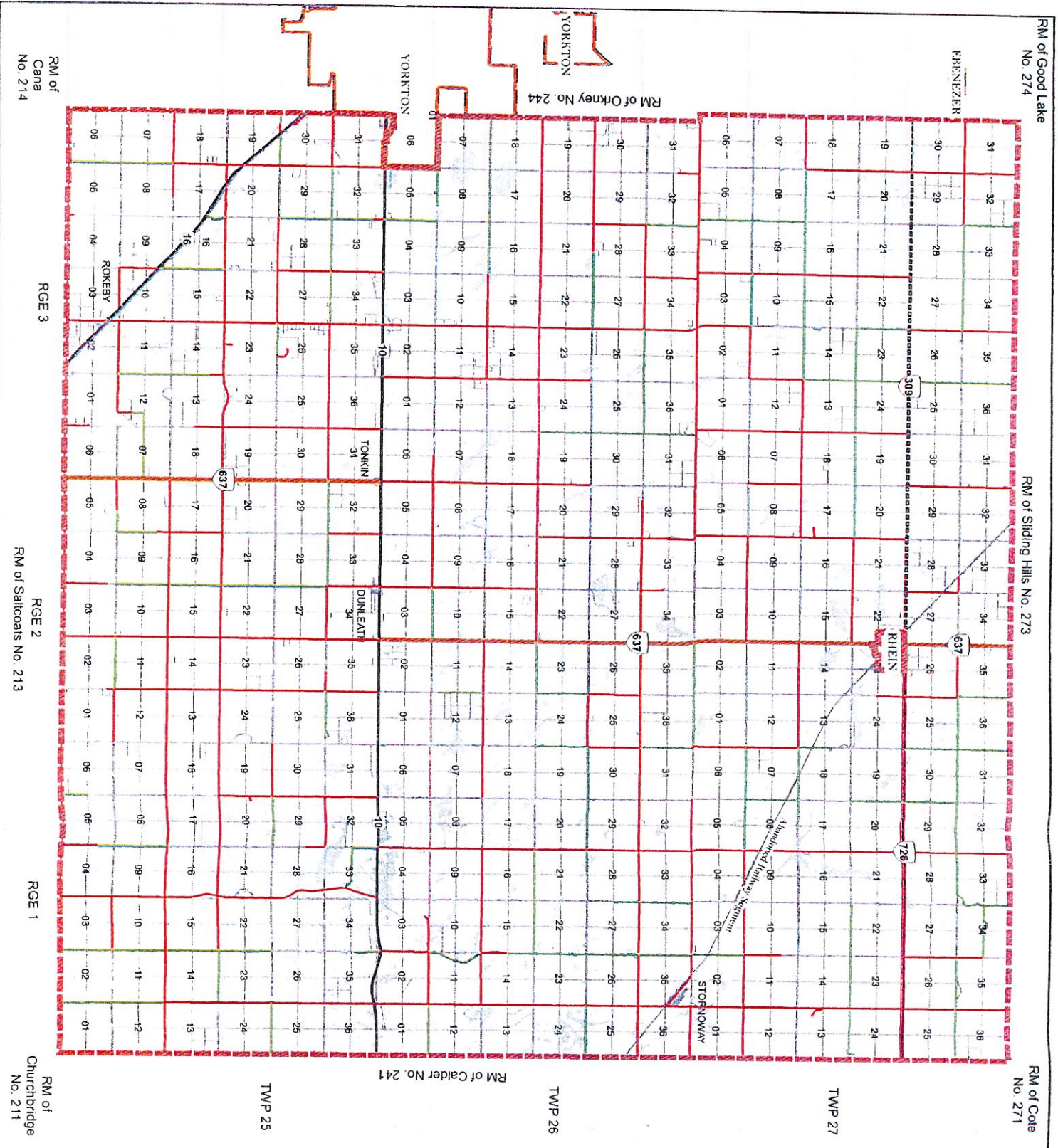

RURAL MUNICIPALITY OF WALLACE No. 243

SASKATCHEWAN

Map 3. Transportation

- Railways
- Highway (Primary)
- Highway (Secondary)
- CTP - Primary Weight
- Primary Grid Route
- All Weather Road
- Summer Road

- Watercourse
- Waterbody
- Urban Municipality
- RM Boundary



RM of Good Lake
No. 274

RM of Sliding Hills No. 273

RM of Cole
No. 271

EBBENZER

RM of Orkney No. 244
YORKTON

YORKTON 08

RM of
Cana
No. 214

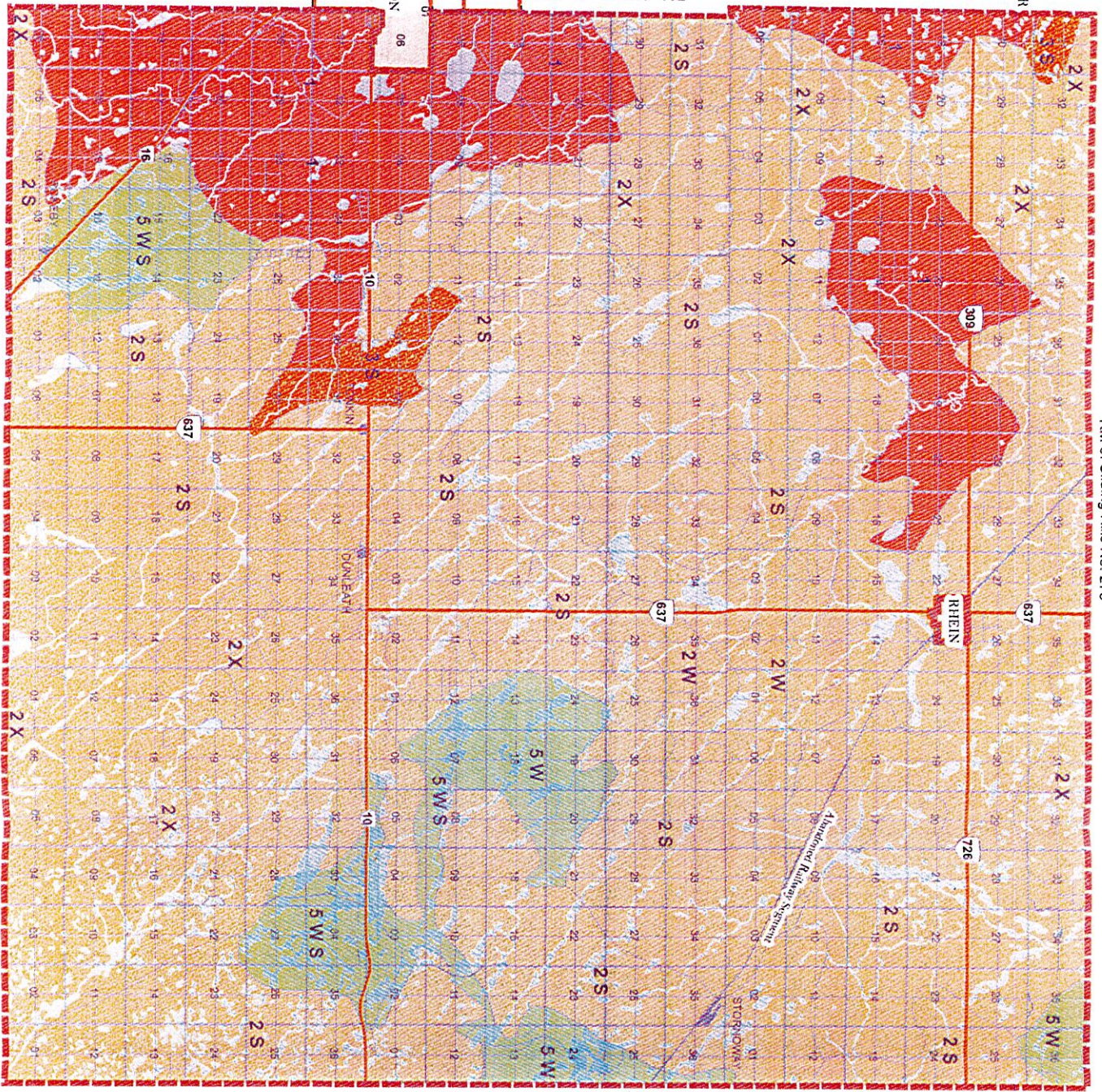

RGE 3

RGE 2
RM of Saltcoats No. 213

RGE 1

RM of
Churchbridge
No. 211

TWP 25

TWP 26

TWP 27

RURAL MUNICIPALITY OF WALLACE NO. 243

SASKATCHEWAN

Map 4. Agricultural Potential

- SOIL CAPABILITY**
- CLASS 1
 - CLASS 2
 - CLASS 3
 - CLASS 4
 - CLASS 5
 - CLASS 6

- SUBCLASS C: ADVERSE CLIMATE
- SUBCLASS E: EROSION DAMAGE
- SUBCLASS I: INUNDATION
- SUBCLASS P: STONINESS
- SUBCLASS R: SHALLOW SOILS
- SUBCLASS S: SOIL LIMITATIONS
- SUBCLASS T: ADVERSE TOPOGRAPHY
- SUBCLASS W: EXCESS WATER
- SUBCLASS X: MORE THAN ONE LIMITATION

- Railways
- Major Highways
- Watercourse
- Waterbody
- Urban Municipality
- RM Boundary

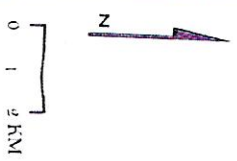

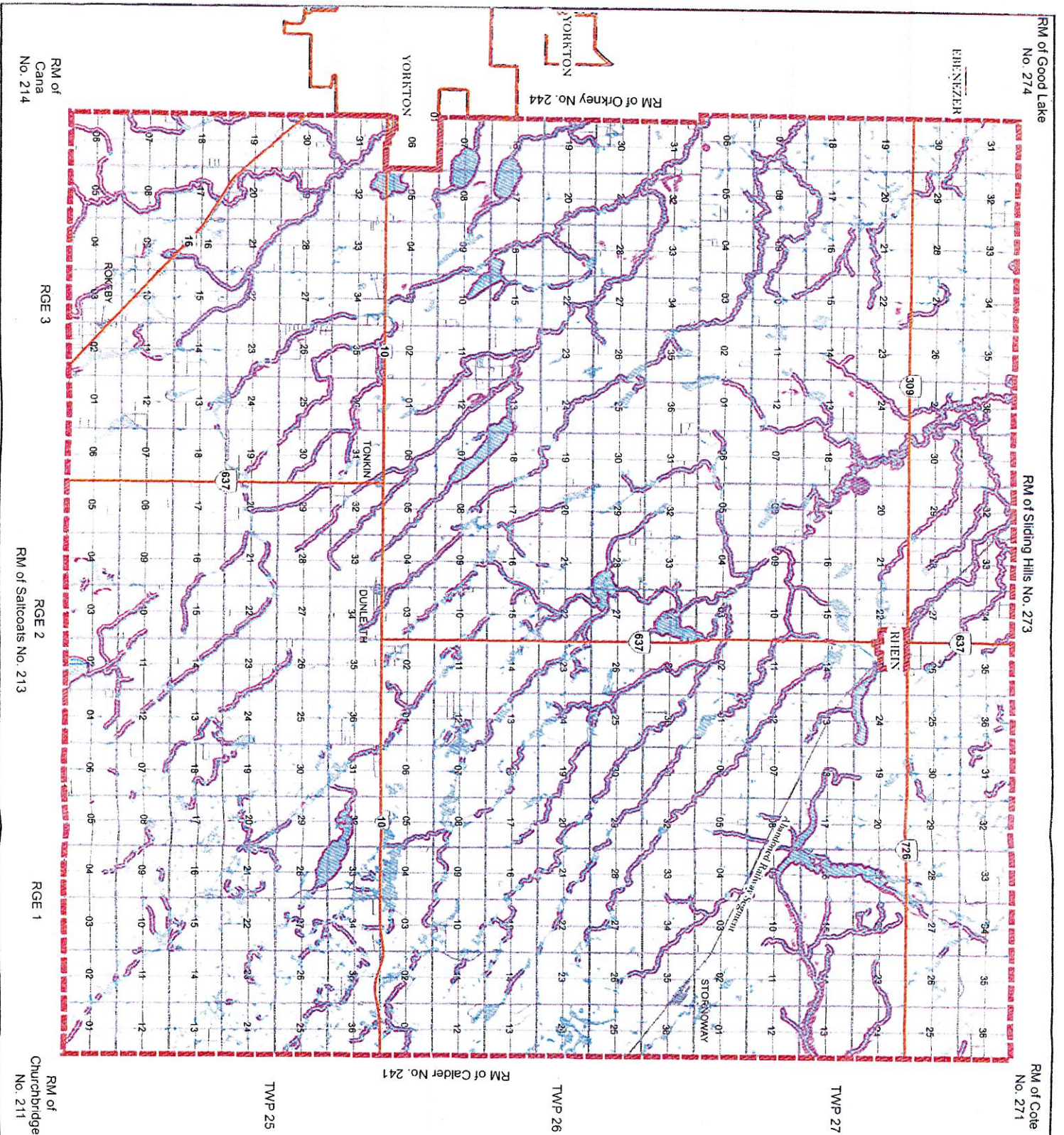

RURAL MUNICIPALITY OF WALLACE NO. 243

SASKATCHEWAN

Map 5. Environmentally Sensitive Areas



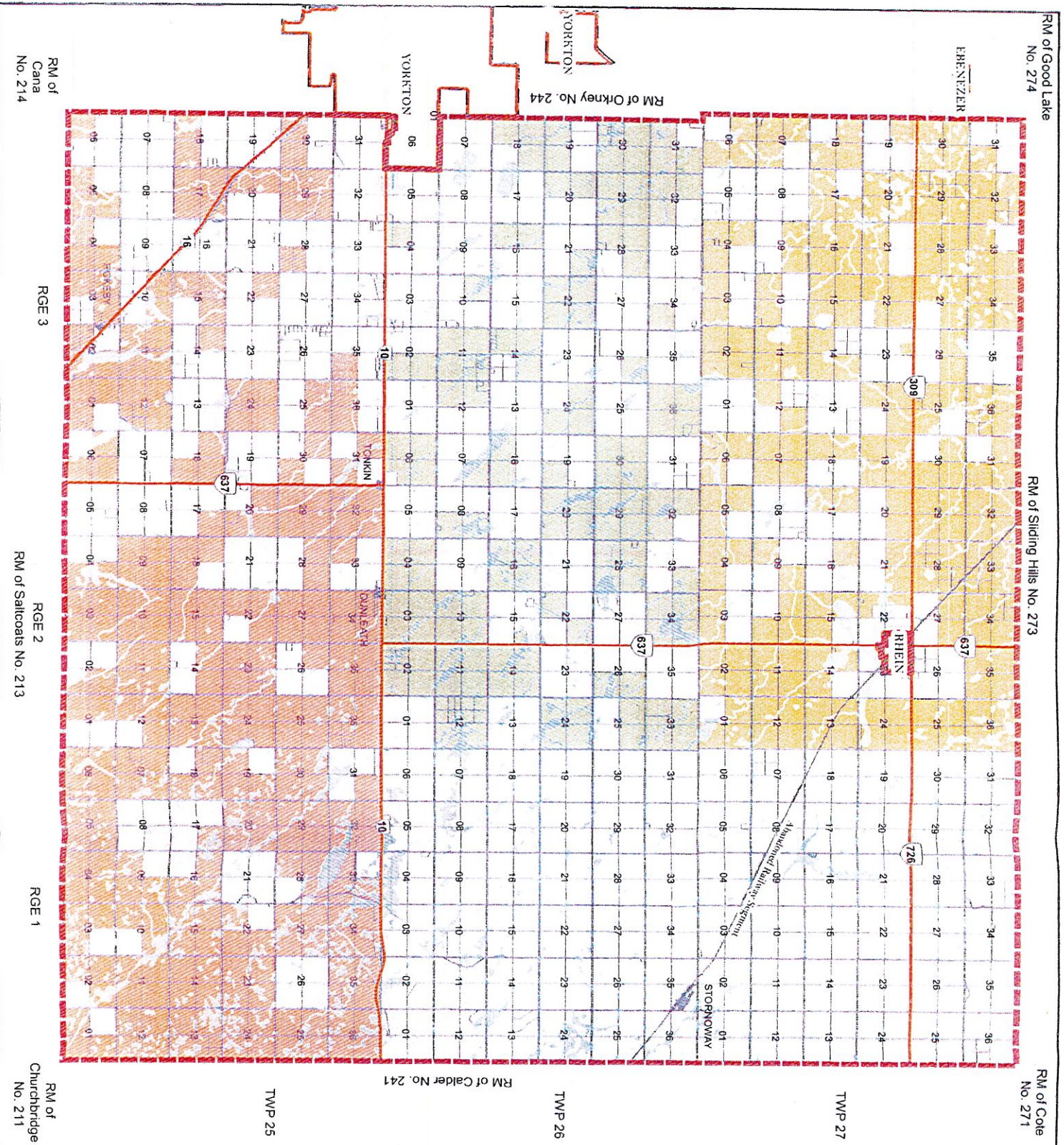

RURAL MUNICIPALITY OF WALLACE NO. 243

SASKATCHEWAN

Map 6. Potash Dispositions

- Potash Disposition Holder**
- AgriKaliM Mining Corporation
 - AgriKaliM Mining Corporation
 - K+S Potash Canada General Partnership

- Railways
- Major Highways
- Watercourse
- Waterbody
- Urban Municipality
- RM Boundary

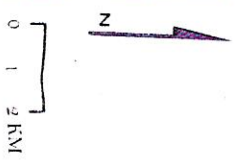

RM of Good Lake
No. 274

RM of Sliding Hills No. 273

RM of Cole
No. 271

EHFNEZER

RM of Orkney No. 244
YORKTON

YORKTON 06

RM of
Cana
No. 214

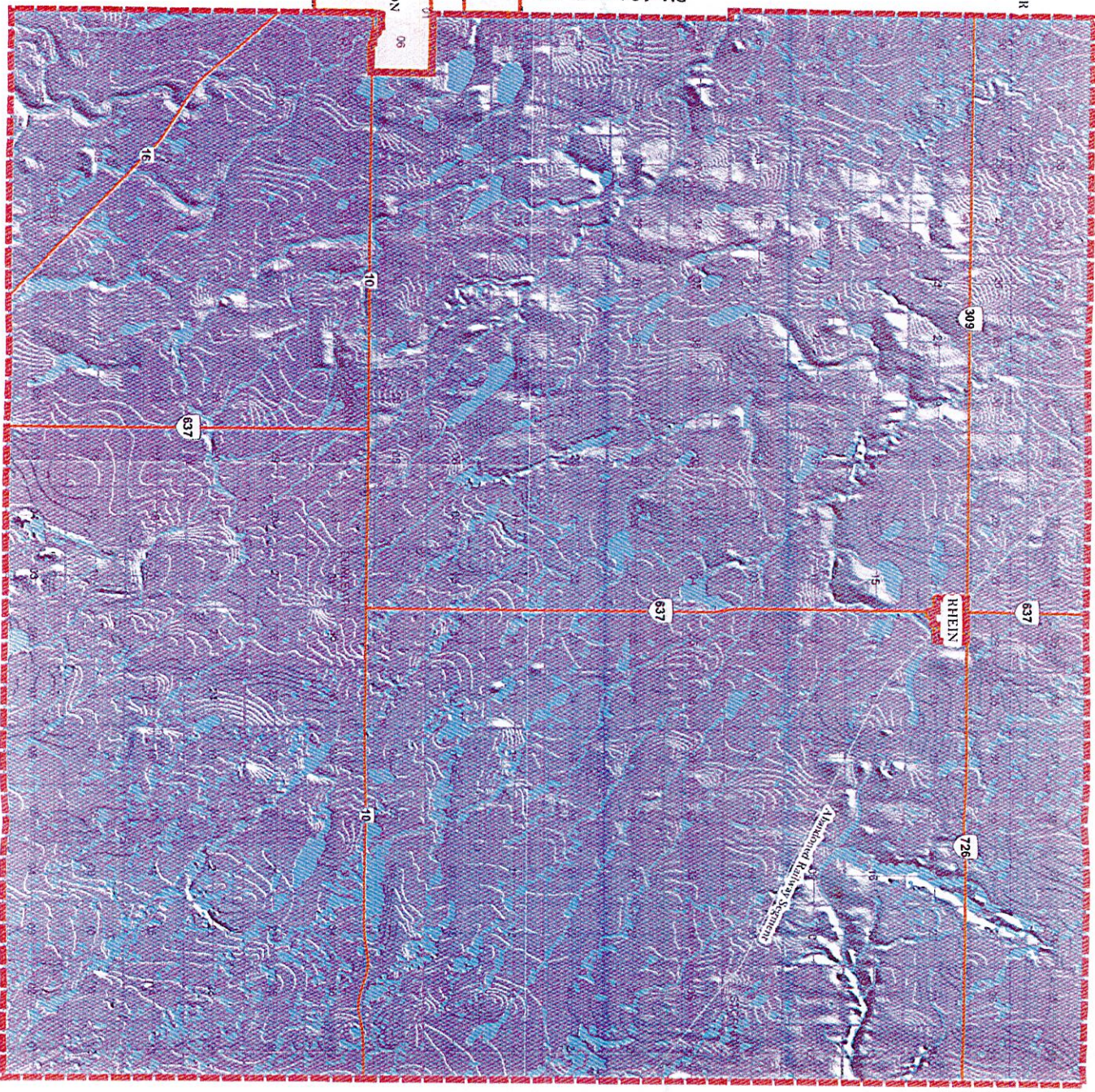

RURAL MUNICIPALITY OF WALLACE NO. 243

SASKATCHEWAN

Map 7. Shaded Relief - Drainage

-  Railways
-  Major Highways
-  Watercourse
-  Waterbody
-  Urban Municipality
-  RM Boundary



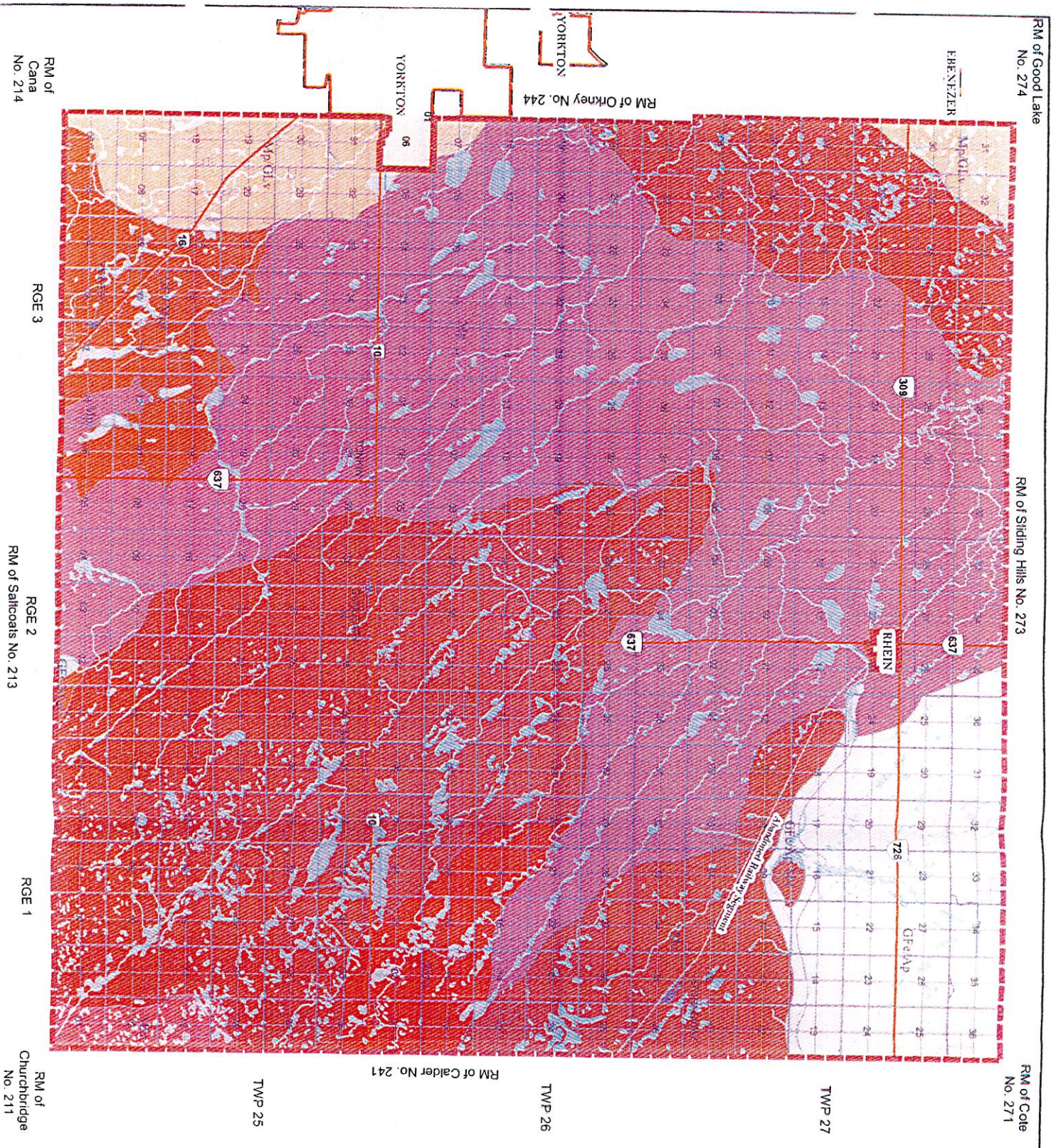

RURAL MUNICIPALITY OF WALLACE NO. 243

SASKATCHEWAN

Map 8. Surficial Geology

- GFe/AP - Glaciofluvial eroded
- GFv/MUe - Glaciofluvial
- MBw - Morainal
- Mhr - Morainal hummocky
- Mp - Morainal plain
- Mp/GLv - Morainal plain
- Mu - Morainal undulating

- Railways
- Major Highways
- Watercourse
- Waterbody
- Urban Municipality
- RM Boundary

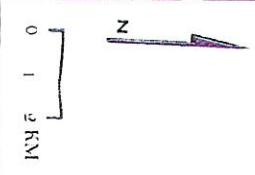

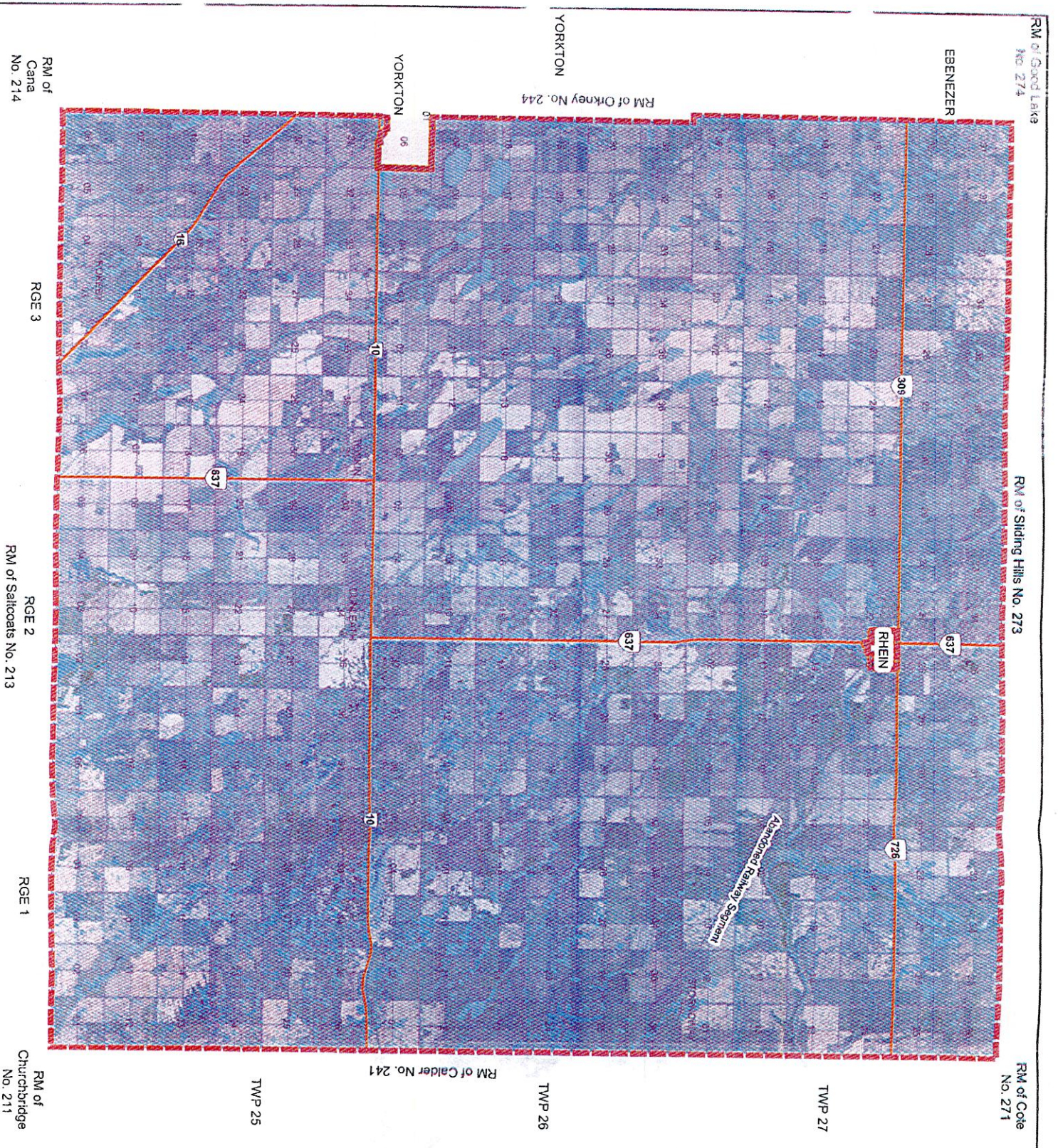

RURAL MUNICIPALITY OF WALLACE NO. 243

SASKATCHEWAN

Map 9. Airphoto



-  Railways
-  Major Highways
-  Watercourse
-  Waterbody
-  Urban Municipality
-  RM Boundary

RM of Good Lake No. 274
 RM of Sliding Hills No. 273
 RM of Cote No. 271

ERENEZER

YORKTON
 RM of Orkney No. 244

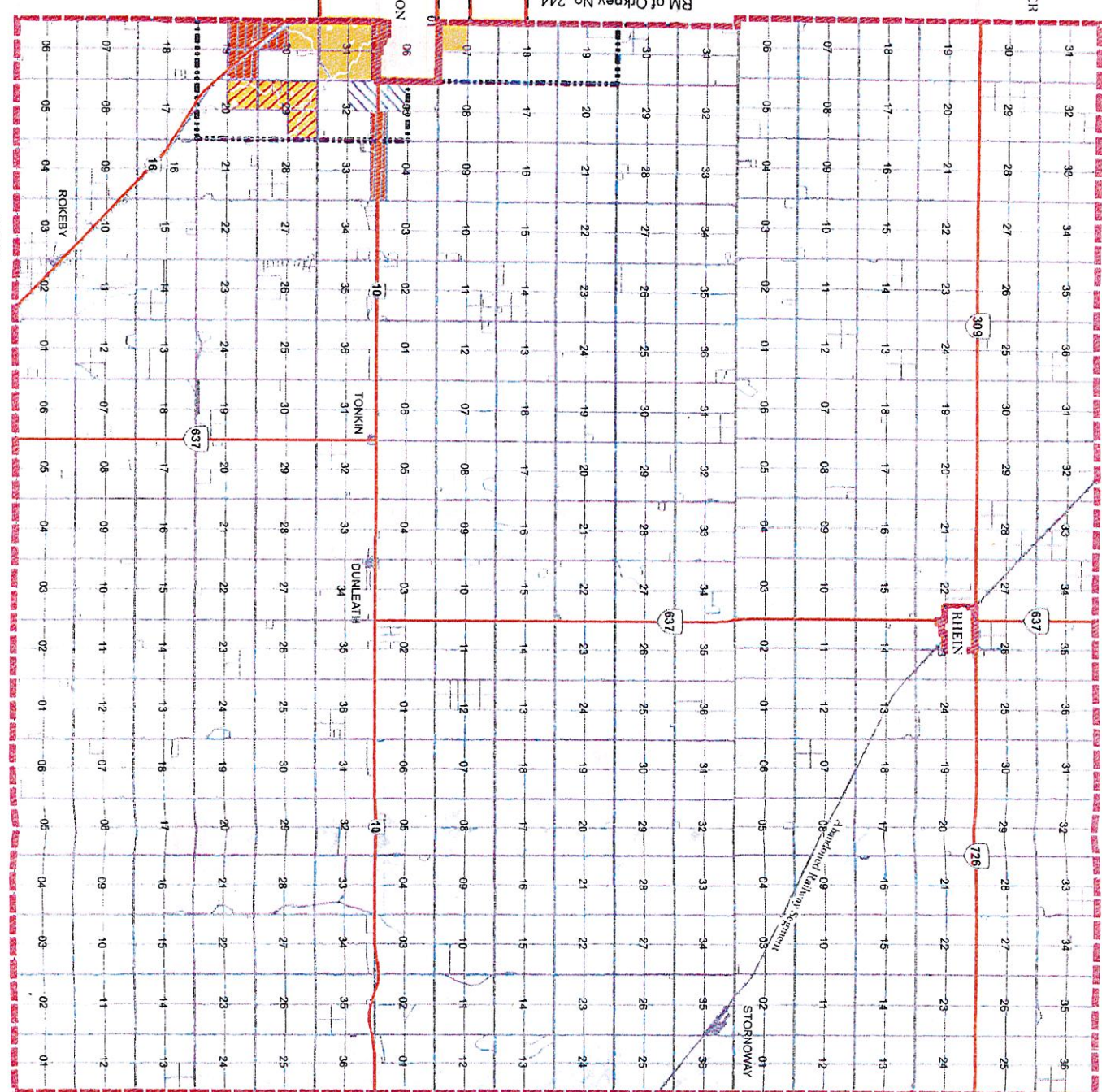

RM of Cana No. 214
 RGE 3
 RM of Saltcoats No. 213
 RGE 2
 RGE 1
 RM of Churchbridge No. 211
 TWP 25
 TWP 26
 TWP 27

RURAL MUNICIPALITY OF WALLACE No. 243 SASKATCHEWAN

- Future Commercial Development
- Future Industrial Development
- Future Residential Development
- RM Future Commercial/Industrial
- RM Future Residential
- RM Future Commercial/Industrial - Limited Services
- Future Study Area - First Nations Lands





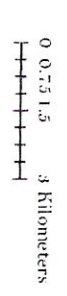

- Railways
- Major Highways
- Watercourse
- Waterbody
- Joint Management Area
- Urban Municipality
- RM Boundary

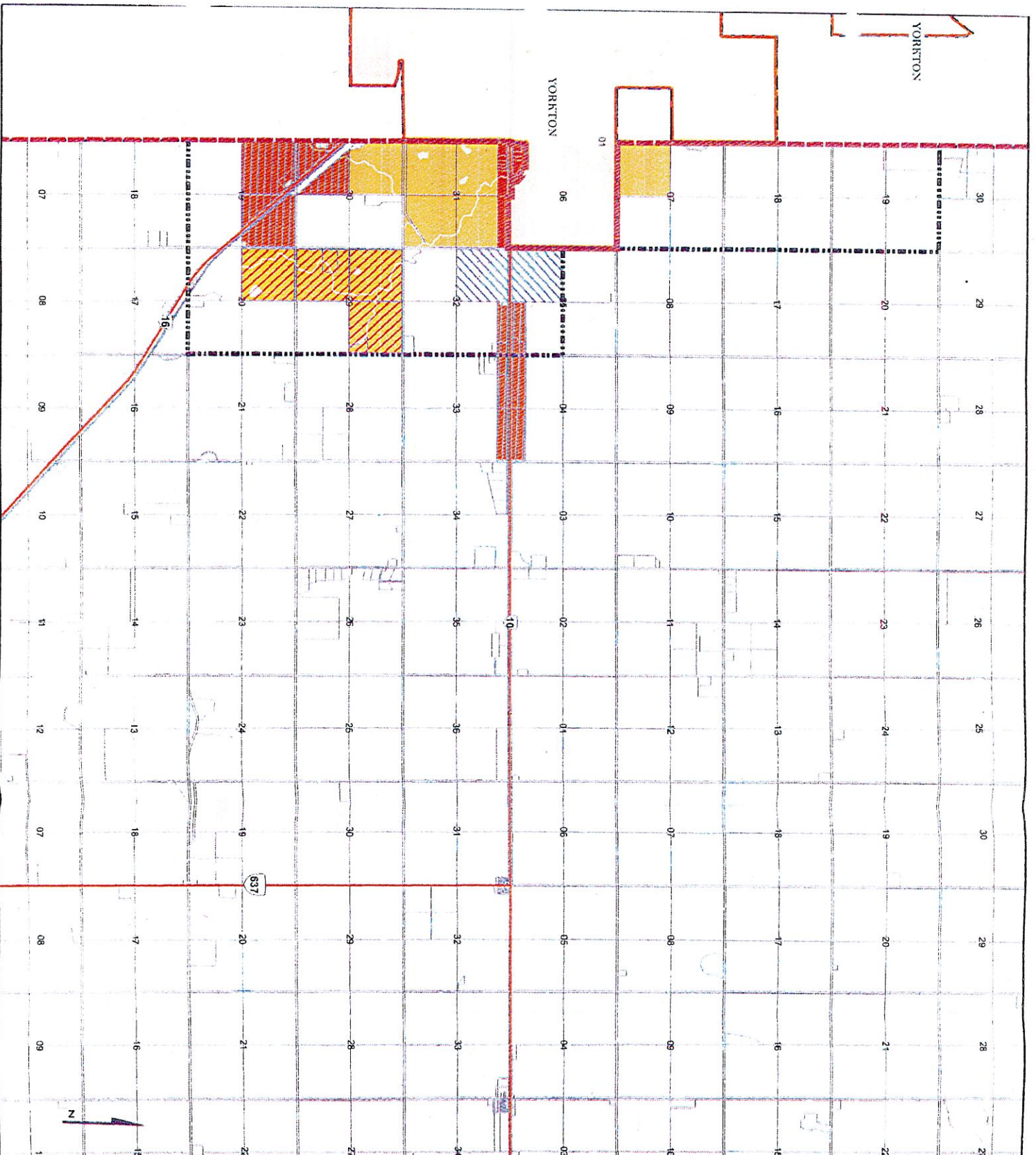





Future Land Use Map



**RURAL MUNICIPALITY OF
WALLACE No. 243
SASKATCHEWAN**



-  Future Commercial Development
-  Future Industrial Development
-  Future Residential Development
-  RM Future Commercial/Industrial
-  RM Future Residential
-  RM Future Commercial/Industrial - Limited Services
-  Future Study Area - First Nations Lands

-  Railways
-  Major Highways
-  Watercourse
-  Waterbody
-  Joint Management Area
-  Urban Municipality
-  RM Boundary

**Future Land Use Map
City of Yorkton Area**

0 0.4250 85 1.7 Kilometers